

FAG

6005

Deep groove ball bearing

Schaeffler ID:
0167172440000Deep groove ball bearing 60, single row,
steel sheet metal cage

Technical information

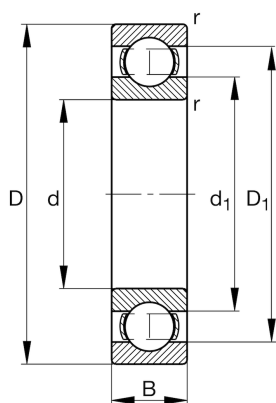
**Main Dimensions & Performance Data**

d	25 mm	Bore diameter
D	47 mm	Outside diameter
B	12 mm	Width
C_r	10,700 N	Basic dynamic load rating, radial
C_{0r}	5,900 N	Basic static load rating, radial
C_{ur}	315 N	Fatigue load limit, radial
n_G	21,900 1/min	Limiting speed
n_{gr}	15,200 1/min	Reference speed
	77.122 g	Weight

Dimensions

r_{min}	0.6 mm	Minimum chamfer dimension
D_1	40.2 mm	Shoulder diameter outer ring
d_1	32 mm	Shoulder diameter inner ring

Mounting dimensions

$d_{a min}$	28.2 mm	Minimum diameter shaft shoulder
$D_{a max}$	43.8 mm	Maximum diameter of housing shoulder
$r_{a max}$	0.6 mm	Maximum fillet radius

Calculation factors

f_0	14.6	Calculation factor
-------	------	--------------------

Temperature range

T_{min}	-30 °C	Operating temperature min.
T_{max}	120 °C	Operating temperature max.